

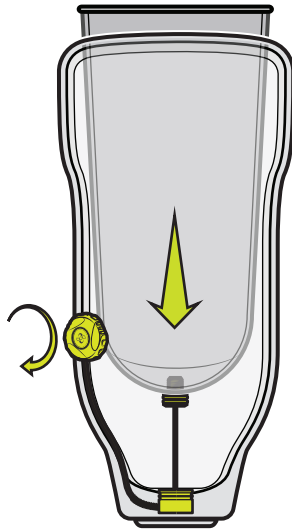

RevoLock™ Lanyard

by CLICK

PK3000-220-05



Need help? www.clickmedical.co/revolock

Revised 2019

Patent Pending

Kit Contents

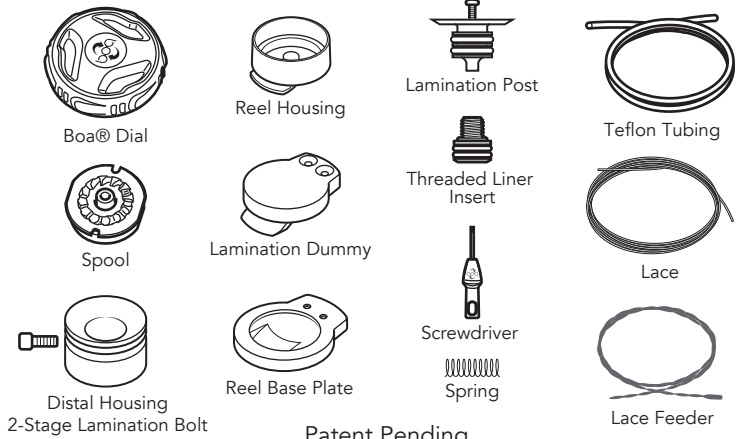

Patent Pending



Advisory

Must be installed by a professional trained in RevoLock™ fabrication. Lace will wear. At minimum, inspect monthly and replace every 6 months. Loss of suspension can occur if lace fails. Do not use on patients with nerve issues. Keep lace away from open flame and sharp edges. Secure insert to liner before tensing system. See advisories in other languages @ www.clickmedical.co/advisories



WARRANTY:

www.clickmedical.co/terms/#warranty

U.S. Customers:

Contact Click Medical directly
Help@ClickMedical.co
Help Line: +1 970 670 7012

International Customers:

Please contact your local distributor

1 Apply attachment post to model.

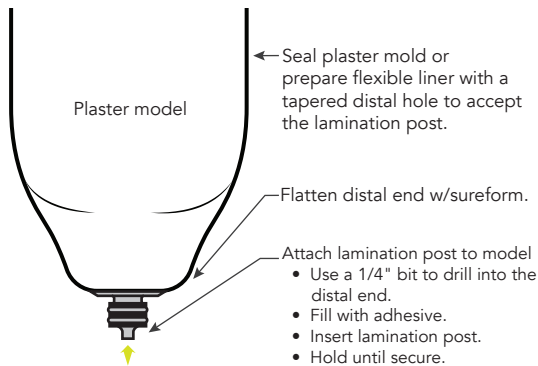

2 Apply PVA bag.

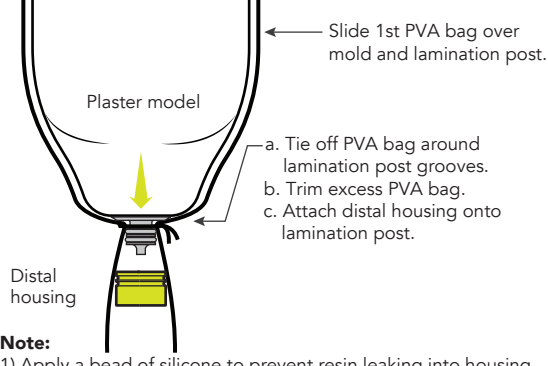

Note:
1) Apply a bead of silicone to prevent resin leaking into housing.
2) Orient tubing port towards desired reel location.

3 Materials layup:

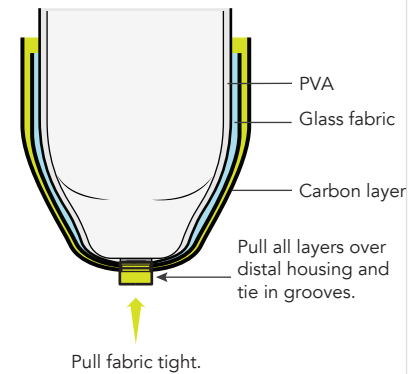

4 Install tubing

Single-Stage Lamination

- 1) Insert tubing and spring.
- 2) Laminate with resin.

2-Stage Lamination

- 1) Install bolt into distal housing. Add clay to bolt head.
- 2) Laminate with resin.
- 3) Grind down to expose head of bolt, then extract bolt.
- 4) Insert tubing and spring into distal housing.

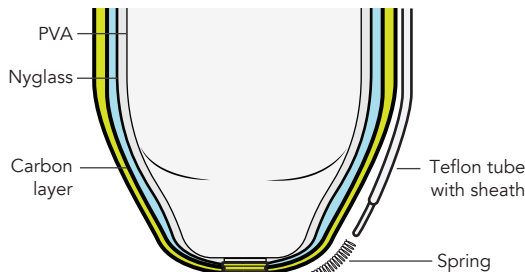

Insert clay into end of tube.

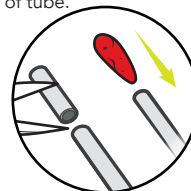

a. Connect spring and tube to distal housing.

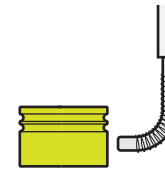

b. Slide Teflon tube into distal housing until fully seated.

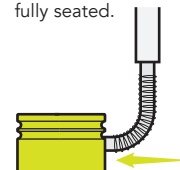

c. Slide spring over Teflon and into distal housing to lock tube into place.

Be careful not to kink the tubing.

Pack clay around tubing prior to lamination.



5 Position tube along side of socket.

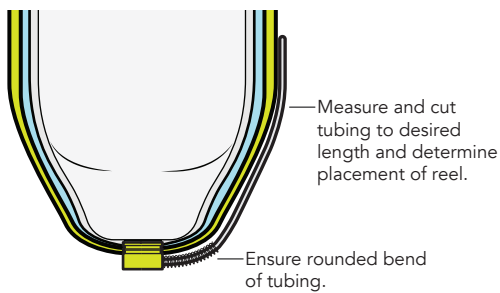

6 Place reel housing and connect tube.

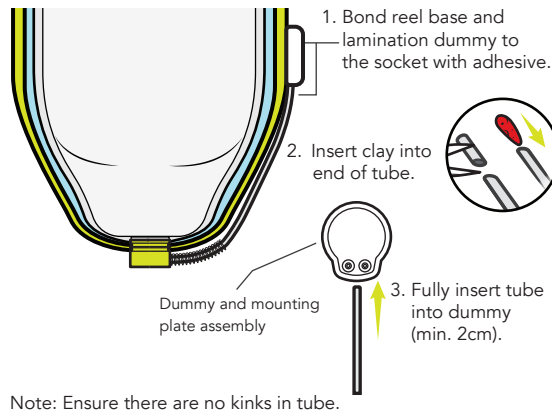

7 Laminate outer layer.

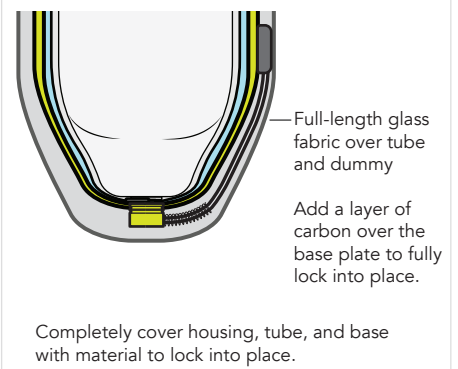

8 After laminating, grind down to expose dummy.

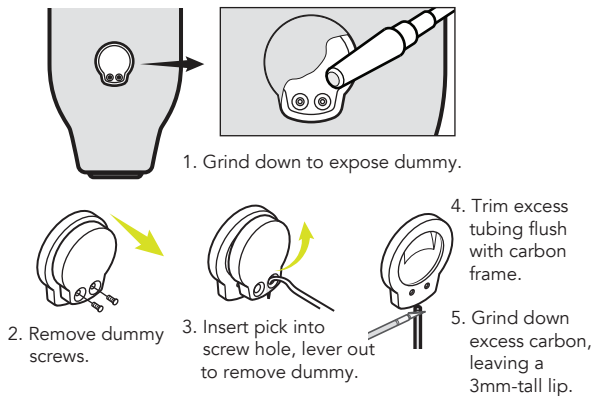

9 Remove model and lamination post.

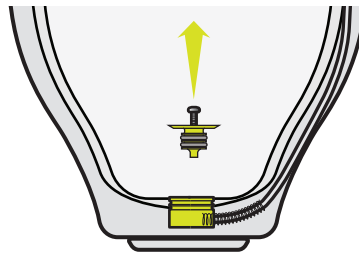

10 Insert reel housing.

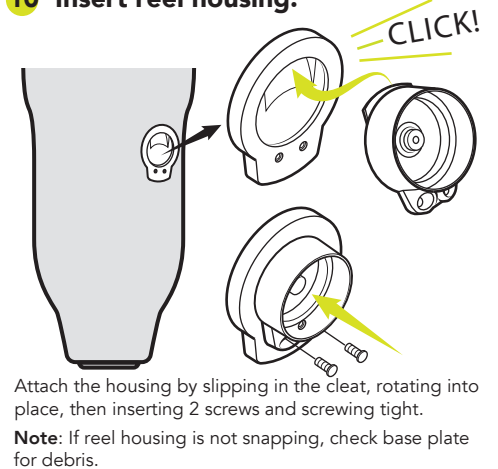

11 Lace the system.

Clean out the tubing with compressed air.

Using lace feeder, route lace from the reel housing into the tube, and through the distal housing into the socket

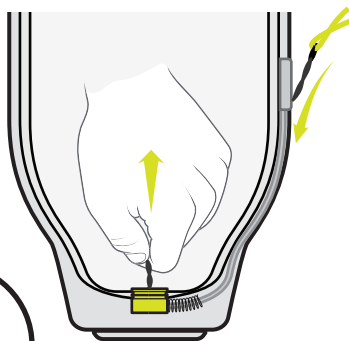
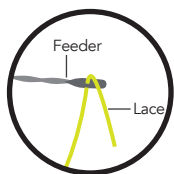

12 Attach the lace to the spool.

- (A) Using a lace feeder, insert lace and tie double overhand knot. (B) Once knot is tied, pull up on lace to seat spool into housing.

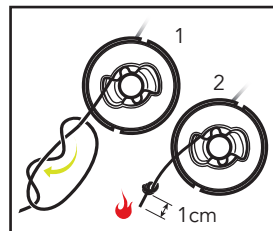

Make sure knot and lace end are tucked into recess of spool.

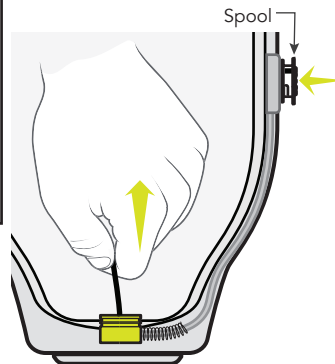

13 Attach dial to housing.

Check dial for any wobble to ensure proper install. Dial should not wobble.



Torque setting for dial attachment is 45in-oz

Note: Overturning can break post; under-tightening can create dial wobble.

14 Determine lace length.

Determine how much lace is needed to extend outside of socket and attach to liner and to the threaded insert.

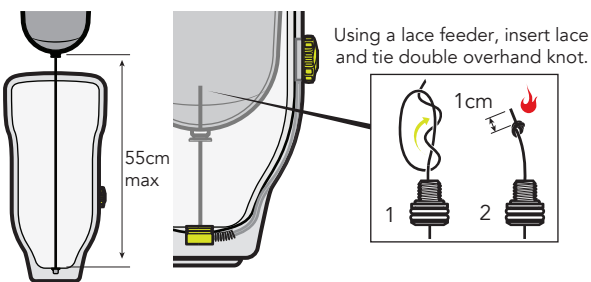

Note: Max lace length cannot exceed 55cm.

15 Test for function.

- Attach threaded insert to liner.
- Wind up lace.
- Pull dial out to release.
- Pull liner and lace out of socket.
- Wind up lace again.

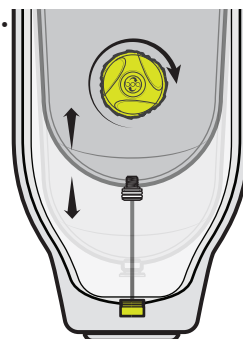

Note:

Inspect lace routinely for signs of fraying or fatigue. Replace lace every 6 months. Keep lace away from open flame.

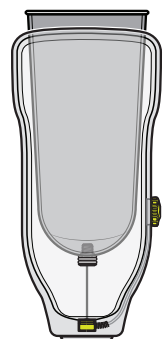

✓ Congratulations, you are finished!



<table border="1"> <tr><td colspan="2">MD</td></tr> <tr><td>EC</td><td>REP</td></tr> </table>		MD		EC	REP	<p>MDSS GmbH. Schiffgraben 41 30175 Hannover Germany</p>	
MD							
EC	REP						
<table border="1"> <tr><td>CH</td><td>REP</td></tr> </table> <p>MDSS CH GmbH. Laurenzenvorstadt 61 5000 Aarau Switzerland</p>	CH	REP	<table border="1"> <tr><td>UK</td><td>REP</td></tr> </table> <p>MDSS-UK RP LIMITED 6 Wilmslow Road, Rusholme M14 5TP Manchester United Kingdom</p>	UK	REP		
CH	REP						
UK	REP						
		<p>Click Medical, LLC 1205 Hilltop Parkway, W101 Steamboat Springs, CO, 80487, USA • 1-970-670-7012</p>					

RevoLock® FAQs

Q: How much weight does it hold?

A: The weight of the patient is managed mostly by the socket frame, rather than by the RevoLock system. As long as you do not intend to hang by your feet on a regular basis, then the RevoLock system can be used on just about any patient weight.

Q: What if the lace breaks?

A: The RevoLock system is robust and holds up well over time. Even so, laces and dials can break. Each component of the system can be replaced by either you or by your prosthetist and it only takes a few minutes. Click recommends lace replacement every 6 months.

Q: How strong is the lace and what is it made out of?

A: 300lb Spectra (Dyneema) Lace.

Q: How long does the lace last?

A: The lace can often last the life of the socket. However, we do recommend replacing it every six months. It's easy to do and it ensures that your socket will always be in tip-top condition.

Q: Is RevoLock waterproof?

A: RevoLock is safe to submerge in fresh and saltwater. If you do use the system in salt water, rinse the system with clean water afterward to remove salt and any corrosive elements.

Q: How do I maintain the system?

A: Check the lace often for knots or signs of wear. If either exist, replace the lace with a lace replacement kit. Have your provider look over your system when you visit their office to ensure that the system is functioning optimally.

Q: Can RevoLock be used in conjunction with a suction or elevated vacuum socket?

A: No, the new snap feature is not airtight and the device will not be able to hold suction or EV.