



CLICK
MEDICAL

QuickFit™ Lacer by CLICK

Replacement Reel Kit Size: Lg

RP0200-230-05

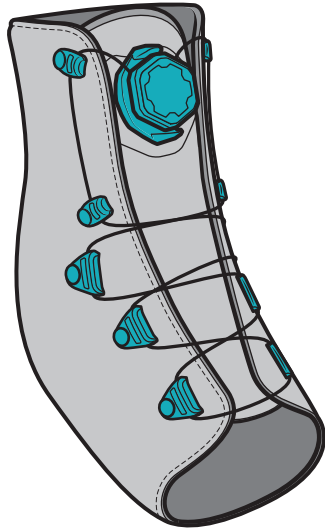

For help and video instructions:
clickmedical.co/quickfit-lacer

Revised 2019

Kit Contents:

1x Replacement Lace, 2.0m

1x Replacement BOA® Reel



Lace Locks



Compatible with:

QuickFit™ Lacer Lg OK0240-230-05

QuickFit™ Lg Releasing Lacer OK0165-230

Advisory



Must be installed by a trained professional.
Lace will wear. At minimum, inspect monthly.
Overtightening could reduce circulation.
Do not use on patients with nerve issues.
Keep lace away from sharp edges.

See advisories in other languages: clickmedical.co/advisories



WARRANTY:

www.clickmedical.co/terms/#warranty

U.S. Customers:

Contact Click Medical directly

Help@ClickMedical.co

Help Line: +1 970 670 7012

International Customers:

Please contact your local distributor

- 1** Pull dial open to release tension. Locate two removal portals on lower reel.

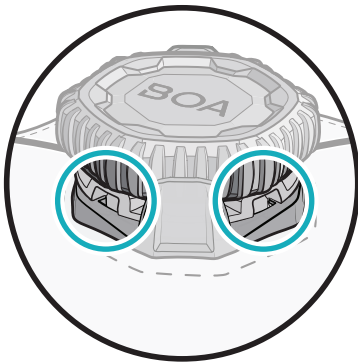

- 2** Fully insert flat-head screwdriver into one of the two ports. Use tool to pry reel upward until cartridge pops out of bayonet.

Repeat on opposite port, releasing reel fully.

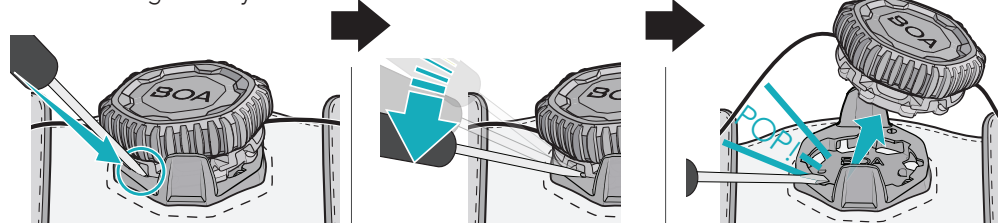

- 3** Snip lace to remove old dial and lace from the system.

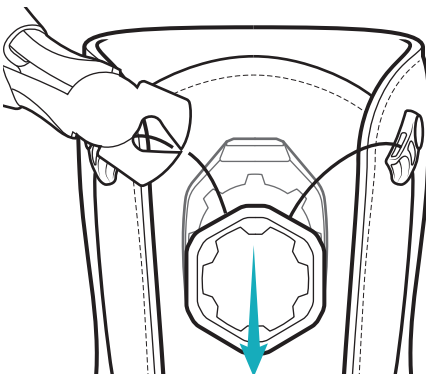

- 4** Use patient to fill device. Feed new lace through all guides.

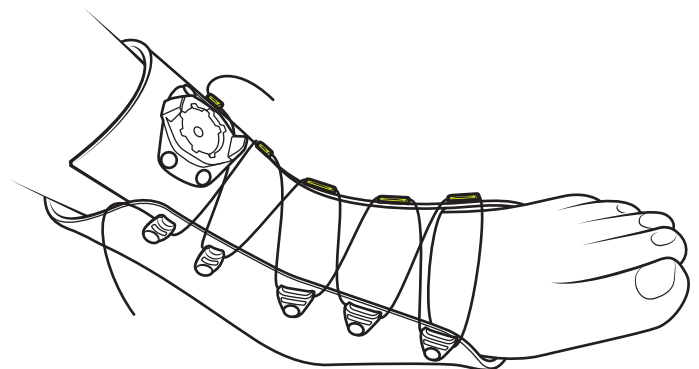

continued:

→ continued:

- 5 Ensure lace is fed through each guide. Pull the lace until tight and measure 10-25cm from the upper guide to the end of the lace. Add 3cm to each lace and cut.

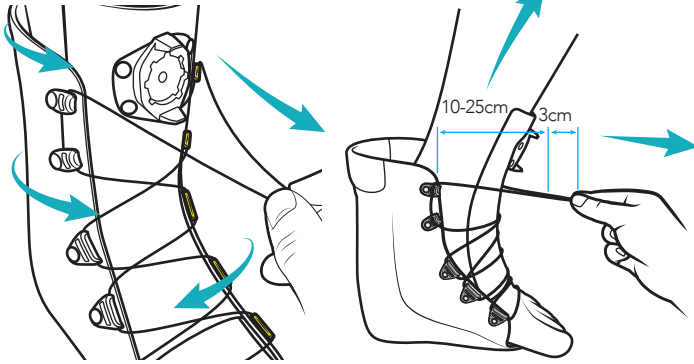

- 6 Press down on new reel to ensure it is closed. Turn the dial until the two arrows align.

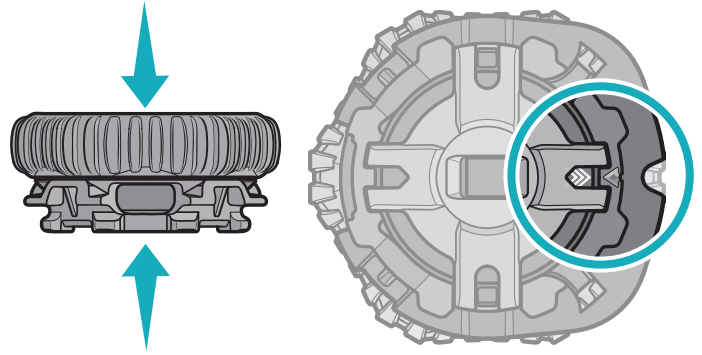

- 7 To assure lace is correctly inserted, feed lace through top exit port and pull through bottom reel window. Repeat for opposite side lace.

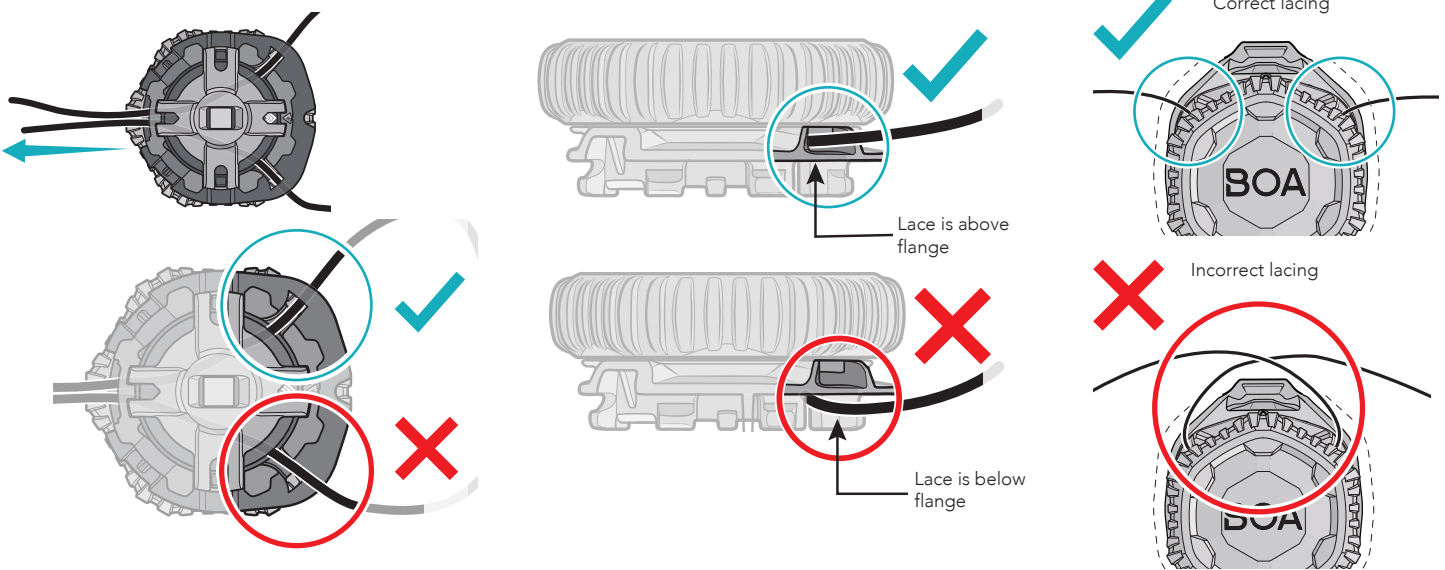

- 8 Hold lace lock with pliers. Push lace through back of hole, then loop lace around backside and through the second hole. Lace tail should be 2.5mm-5.0mm.

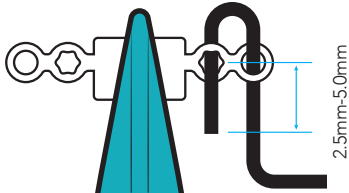

- 9 Pull lace tight to set. Flex lace lock back and forth to break off connector. Pull lace firmly into reel. Repeat for opposite lace.

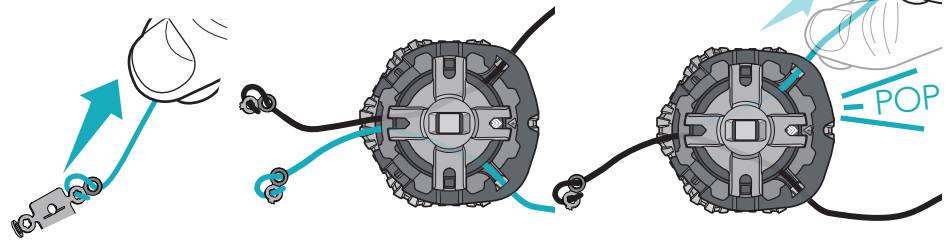

Note: Lace locks and tail should not be visible when lace is seated properly.

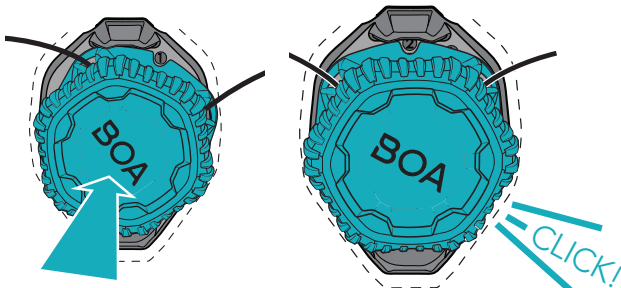

- 10 Insert reel into base by aligning the notch with the #1 on the mounting plate and pushing into place. Then turn reel clockwise. The #2 will then be visible.

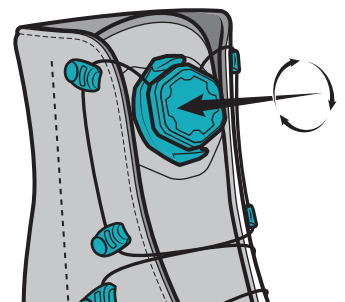

- 11 Pull outward on dial to ensure proper installation then cycle system to test for smooth function: Push to engage. Twist to tighten. Pull to release.

Note: If system feels rough, remove reel (see steps 1-2) and check that knot and tail are seated properly (see step 9).



<table border="1"> <tr><td colspan="2">MD</td></tr> <tr><td>EC</td><td>REP</td></tr> </table>	MD		EC	REP	MDSS GmbH. Schiffgraben 41 30175 Hannover Germany	
MD						
EC	REP					
<table border="1"> <tr><td>CH</td><td>REP</td></tr> </table>	CH	REP	MDSS CH GmbH. Laurenzenvorstadt 61 5000 Aarau Switzerland	<table border="1"> <tr><td>UK</td><td>REP</td></tr> </table>	UK	REP
CH	REP					
UK	REP					
	Click Medical, LLC 1205 Hilltop Parkway, W101 Steamboat Springs, CO, 80487, USA • 1-970-670-7012					