

## QuickFit® Lacer LG Kit Contents:

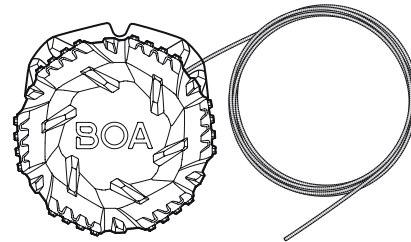

BOA® M4 Dials  
w/1.3 m attached Lace (x2)

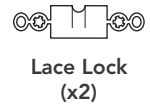

Lace Lock  
(x2)



Rivets  
(x32 post & cap)

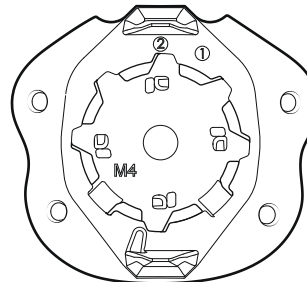

M4 Dial  
Housings (x2)

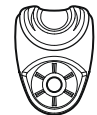

QuickLace  
Guides (x20)

### Installation Hints:

Use QuickFit™ Tool 1/8" punch or other tool to make required holes.

If using existing holes for QuickLace Guides, remove metal or plastic grommets from eyelets to ensure a secure rivet setting.

Rivets can be hand snapped to position for verifying fit, but rivets must be set prior to applying significant closure force to the lace with the reel.

Press rivets at 90° with QuickFit™ Tool or other method; pressing at an angle will result in poor rivet setting.

Secure dial on thicker/sturdier part of tongue.

### Recommended Tools:

- QuickFit™ Tool
- Marker Pen
- Wire Cutters



### Advisory

- Must be installed by a trained professional.
- Lace will wear. At minimum, inspect monthly.
- Overtightening could reduce circulation.
- Do not use on patients with nerve issues.
- Keep lace away from sharp edges.
- See advisories in other languages:  
[clickmedical.co/advisories](https://clickmedical.co/advisories)



### WARRANTY:

[www.clickmedical.co/terms/#warranty](https://www.clickmedical.co/terms/#warranty)

#### U.S. Customers:

Contact Click Medical directly  
 Help@ClickMedical.co • Help Line: +1 970 670 7012

#### International Customers:

Please contact your local distributor

- 1 Determine Guide locations using installation guidelines. Punch holes using 1/8" punch option of QuickFit™ Tool.

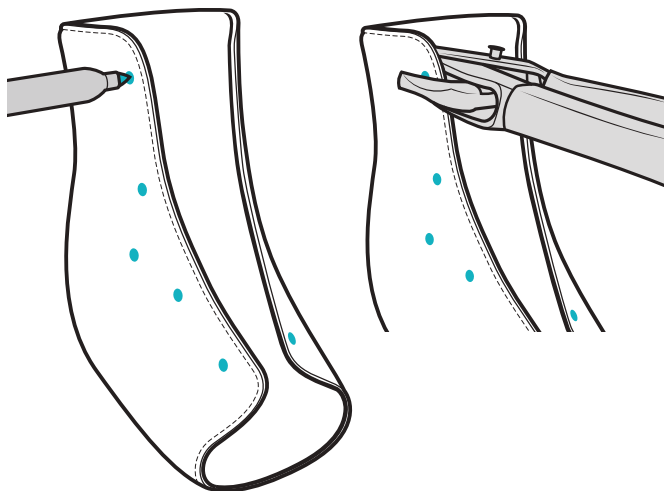

- 2 a) Attach QuickLace Guides by inserting male rivet from inside the device and through QuickLace Guide. b) Snap female rivet cap on top of QuickLace Guide, holding the Guide to the shoe.

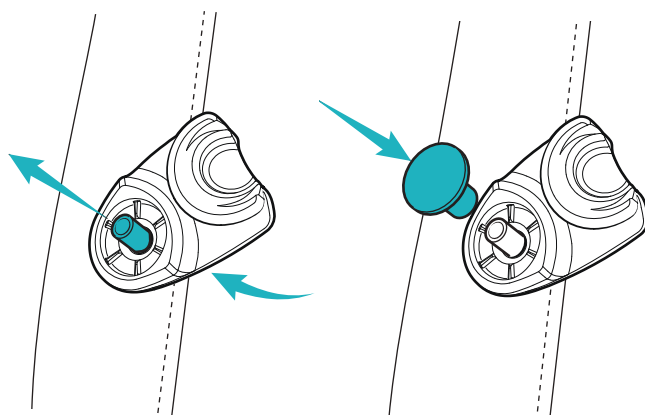

- 3 Once satisfied with Guide placement, secure rivets with setting tool.

Repeat for all Guides.

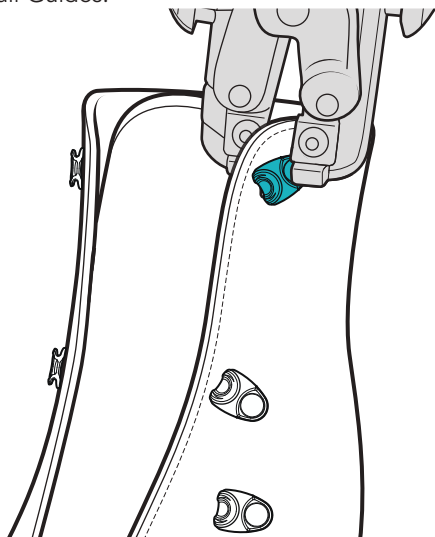

- 4 Determine location of Dial. Allow 1 cm of clearance between top of tongue and top of Housing.

Mark location of all 4 holes.

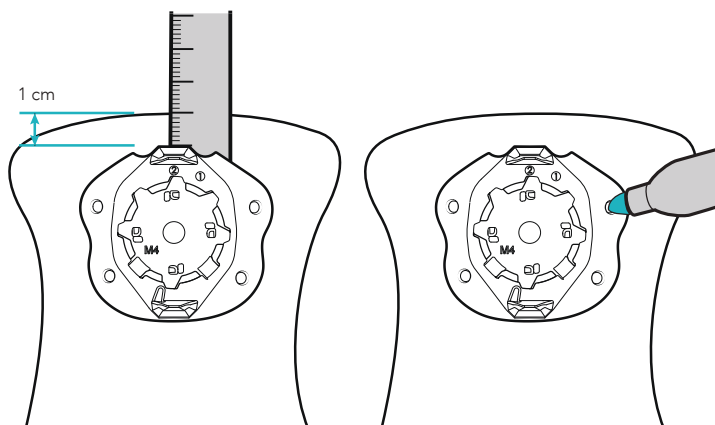

- 5 Punch hole using the 1/8" punch option on QuickFit™ Tool.



- 6 Attach Dial Housing to the tongue. Snap rivets as described in Step 2. If satisfied with placement, secure using QuickFit™ Tool.

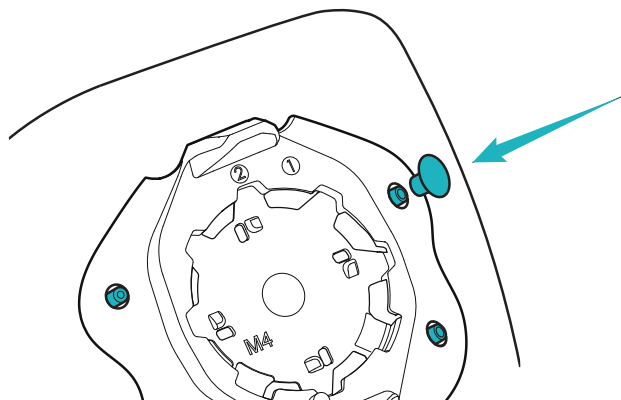

- 7 Lace the Guides as shown.

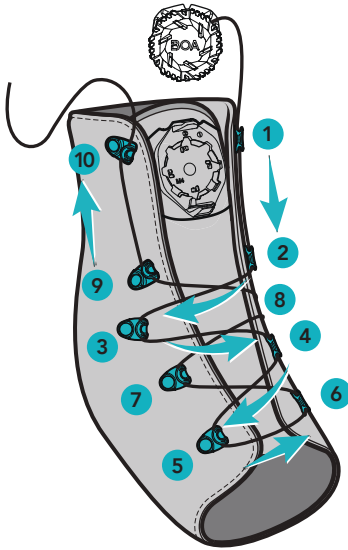

Lace can be fed straight through the Guide (A) or pulled into place (B).

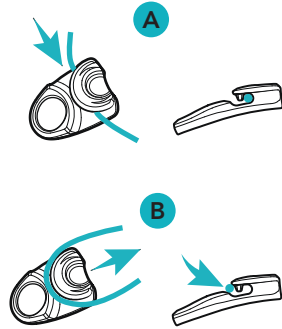

- 8 Pull slack out of lace crossings and measure out ~15 cm of lace from the last guide to the back of the dial. Mark and then trim the lace with wire cutters.

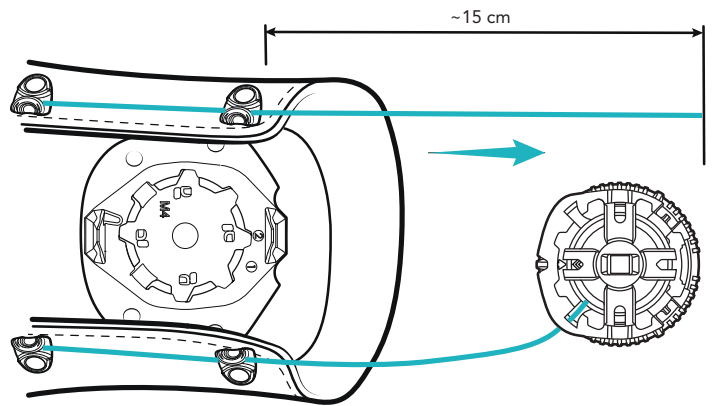

- 9 Feed the free end of the lace into the open lace port, on top of the plastic flange, not under it. Then push the lace through the Dial until it comes out the bottom.

Ensure that the arrows are aligned. If not, rotate Dial while holding the base until arrows align.

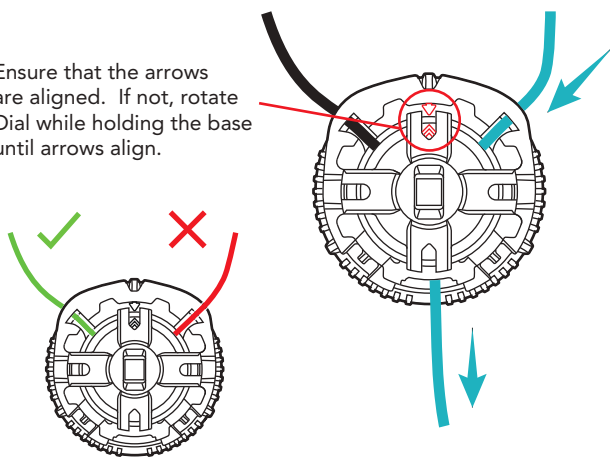

- 10 Thread the Lace Lock as shown below (A) and leave ~5 mm of tail. Pull the knot tight leaving the 5 mm tail (B). Break off the double circle Lace Lock from the base (C) and then pull the knot into the dial body with a firm tug (D).

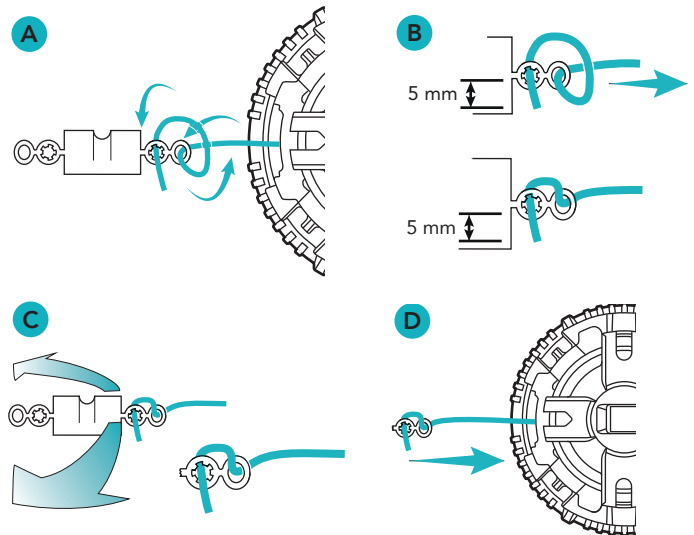

- 11 Align the notch in the Dial base with the number "1" on the Dial Housing and push the Dial into the Housing. Rotate the Dial counterclockwise until the notch is showing the number "2" on the Collar.

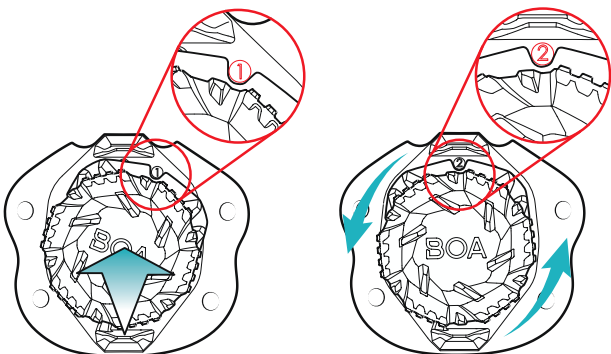

- 12 Test the operation of the system. Turn Dial clockwise to tighten the lace and pull the Dial out to release all tension. Lace can be snapped out of guide for quick donning or doffing.

