



Advisories

Must be installed by a licensed professional.

Lace will wear:

- Routinely check for wear or damage.
- Look for broken black fibers around areas of high wear.
- Replace lace if a significant amount of black fibers are broken.
- Proactively replace lace every 6 months.
- Loss of suspension can occur if lace fails.
- Keep lace away from open flame and sharp edges.

Secure threaded insert to liner with medium thread lock.

Secure snap to threaded insert before tensioning system.

Weight limit: 125 kg

See advisories in other languages: clickmedical.co/advisories



WARRANTY

U.S. Customers:

Contact www.clickmedical.co/terms/#warranty
Help@ClickMedical.co

Tel: +1-970-670-7012

International Customers:

Please contact your local distributor.

U.S. PATENT: #10918502

EU PATENT: PENDING

<div>MD</div> <div>EC REP</div>	MDSS GmbH Schiffgraben 41 30175 Hannover, Germany	
	Click Medical, LLC 1205 Hilltop Parkway, W101 Steamboat Springs, CO, 80487, USA +1-970-670-7012	

RevoLock® Align Kit Contents:

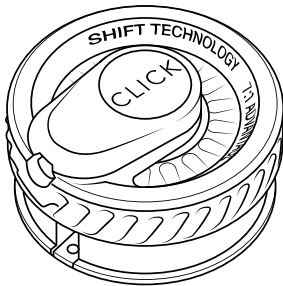

Click® Reel

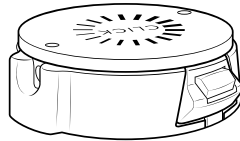

Lamination Collar

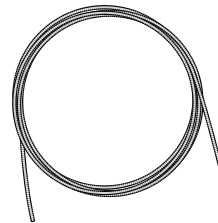

0.5 m
Lamination Tube

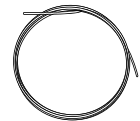

2.0 m
Indicator Lace

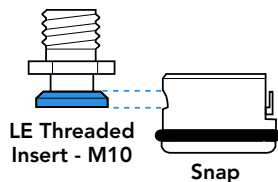

LE Threaded
Insert - M10

Snap

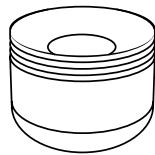

Align Housing + Fabrication Post

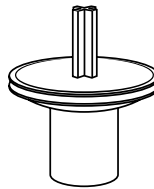

Metal Lace Feeder

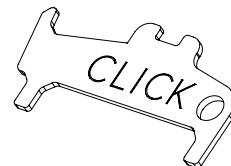

Reel Tool



Plastic Lace
Feeder x 3

Fabrication Overview:

1. Secure lamination post to model.
2. Apply PVA bag.
3. Slide align housing over tube, then insert tube end onto distal end of fabrication post.
4. Slide align housing onto fabrication post.
5. Apply inner fabric layers.
6. Place tube and collar in desired location.
7. Apply outer fabric layers.
8. Perform 1st lamination.
9. Transfer alignment (if making socket adjustable, add RevoFit® kit now).
10. Perform 2nd lamination.
11. Remove model.
12. Lace socket.
13. Attach lace to both the snap and the Click® Reel.
14. Attach snap insert to liner.
15. Install Click® Reel into collar.
16. Attach threaded insert to snap and test for function.

To learn more about fabricating RevoLock®, enroll in [Click Academy](https://clickmedical.co/academy).

For material suggestions and guidelines, please refer to the **Material Data Sheet:** clickmedical.co/mds

Detailed Fabrication Instructions: Two Stage Lamination

⚠ DO NOT EXCEED 15 inHG OF VACUUM PRESSURE DURING LAMINATION

1 Apply lamination post to model:

- Drill 9 mm hole into distal end of model.
- Flatten end of model.
- Backfill hole with plaster or adhesive, to secure post to model.

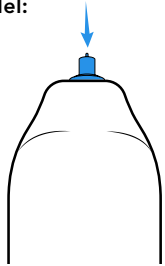

2 Apply PVA bag:

Tie the PVA bag into the groove on post and trim excess.

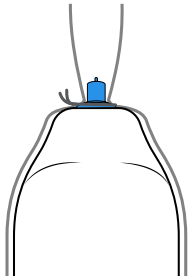

3 Expose 8-10 cm of bare tubing, then slide the align housing onto the tube.

Pack the end of tube with clay and insert firmly onto the distal end nipple.

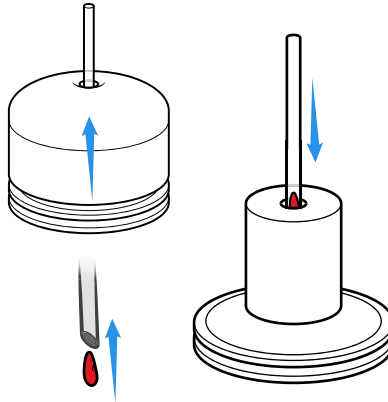

4 Slide distal housing over tube and onto post:

Note: Housing will secure the tube to the post and create an air-tight seal.

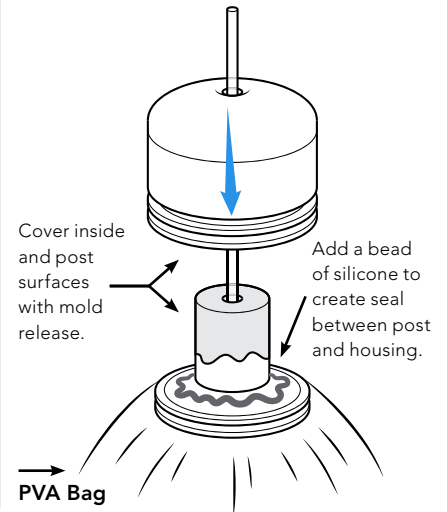

5 Apply inner material layup:

Tie inner fabric layers around tube and reflect over the mold.
Do not pull tube out of the post.

6 Mount the lamination collar in the desired location:

Glue the collar to the outer fabric layer with **Lace Port B** oriented towards the distal end.

7 Install the tubing:

- Carefully bend the tubing -WITHOUT KINKING IT- over the distal end towards the collar.
- Measure the distance to the collar, and add 2 cm.
- Cut the tube to length, pack with clay and insert into the collar (**Lace Port B**).

-- DO NOT KINK THE TUBE --

If the tube kinks, you must replace with a new piece.

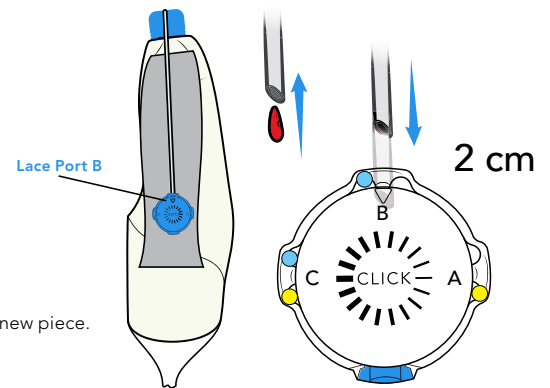

8 Apply outer layers of material.

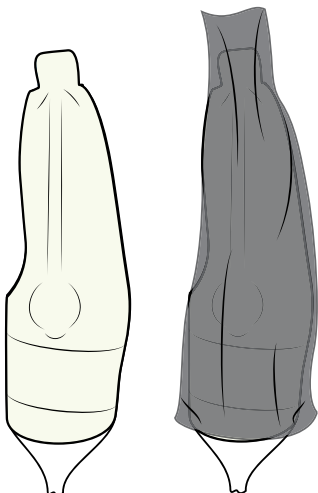

9 Perform 1st lamination.



10 Transfer socket alignment:

Optional: If also adding RevoFit® adjustability, install those components now.

11 Perform 2nd lamination.

12 Remove socket from mold.

Remove lamination post from distal housing.

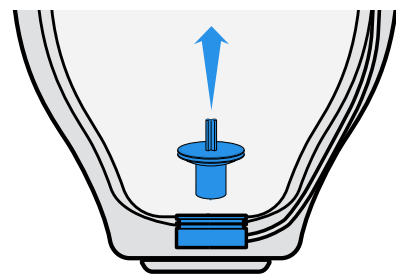

Detailed Fabrication Instructions (continued):

13 Prepare collar:

- Grind to silicone and remove.
- Continue grinding carbon until flat with top of the collar.
- Trim tube.

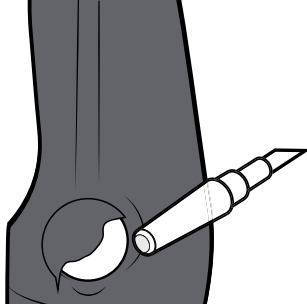

14 Lace the device:

- Use the lace feeder to feed the lace through tubing starting at the collar.

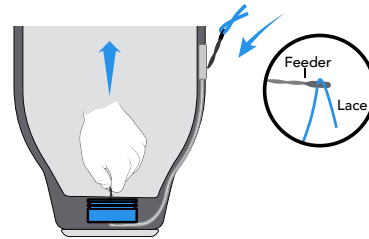

15 Attach lace to the Click® Reel.

Step 1

Orient the reel so that the foot of the reel aligns with the void in the lamination collar opposite of the metal insert.

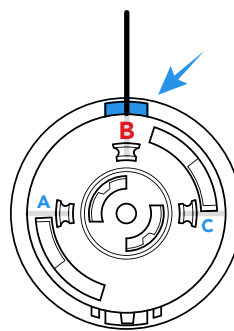
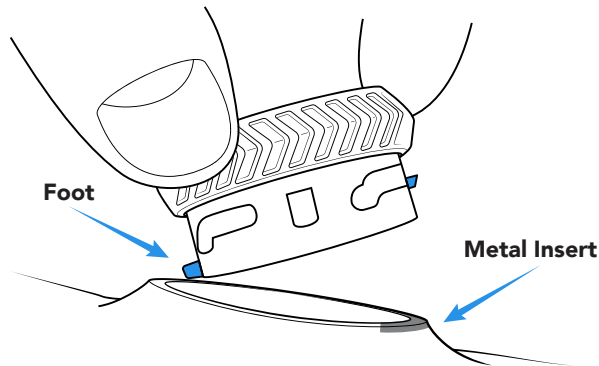

- Use the lace port "B".

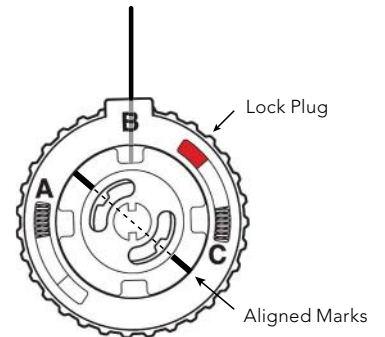

- Ensure lacing windows are aligned. Adjust position by turning dial.

Step 2

Lace the reel using the plastic lace feeder.

Pro Tips:

- Slightly bend the tip of the lace feeder.
- Once inserted into lace hole, twist lace feeder to help exit the lace hole.

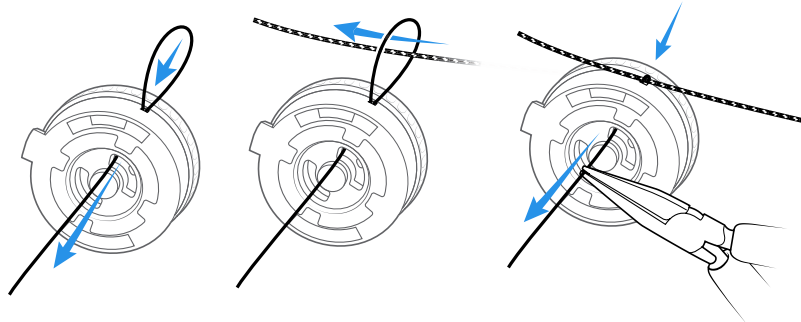

Step 3

Tie an overhand knot at desired length and trim tail.

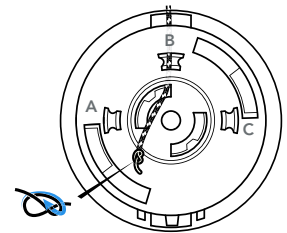

Step 4

Pull lace to seat knot on the far side of the channel midpoint.

Completely push knot into metal hole with a flathead screwdriver.

Channel Midpoint

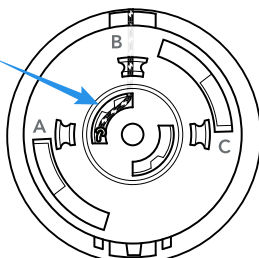

Step 5

Remove the lock plug to engage the Shift® feature of the reel.

Pro Tip: Keep the lock plug for possible future use.

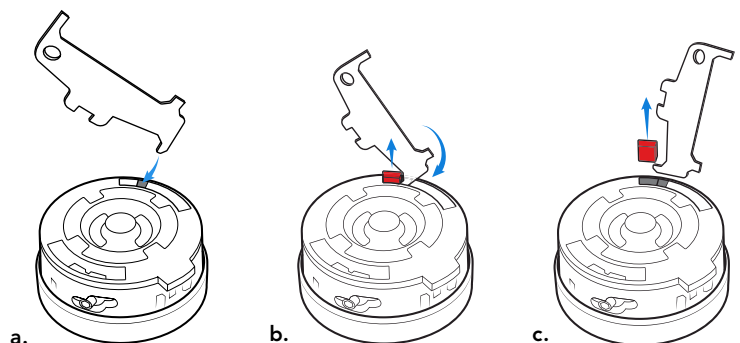

16 Install the Click® Reel.

a. Insert the foot of the reel into collar.

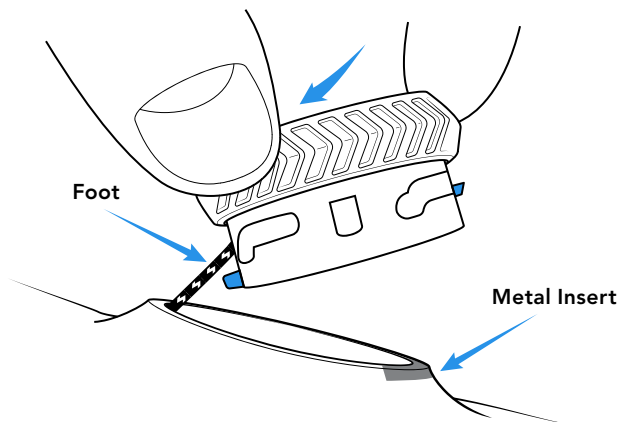

b. Press the reel firmly into the collar (you should hear a "CLICK" when secure).

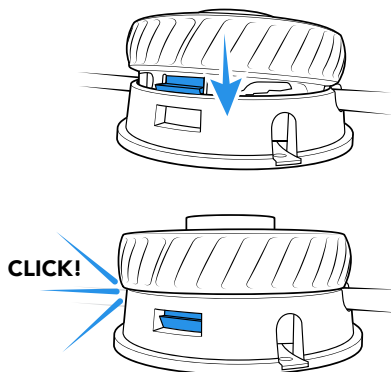

17 Attach Lace to Snap:

a. Determine lace length for the user to easily connect snap parts, and mark the lace.

Note: Max lace length from distal housing = 45 cm.

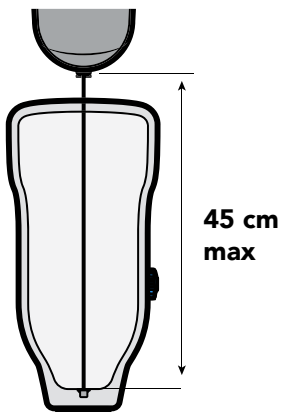

b. Connect the lace to the snap:

1. Thread lace up through the center hole from the bottom of the snap base.
2. Then thread lace down through the knot chamber.
3. Tie a double overhand knot.
4. Seat the knot into the knot chamber by pulling on the lace.
5. Seal the hole with a drop of glue.

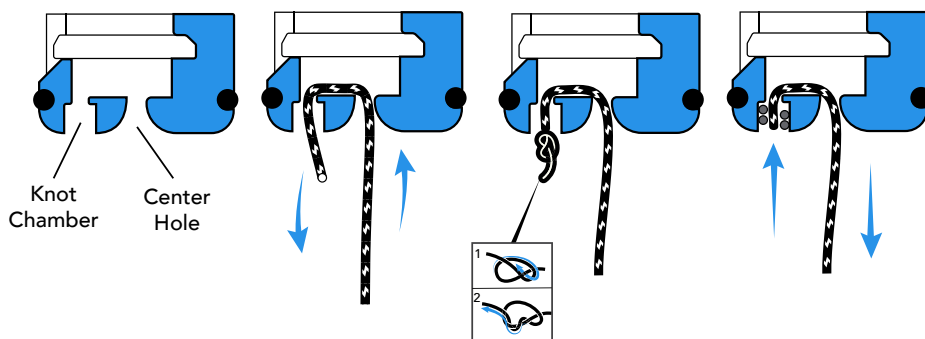
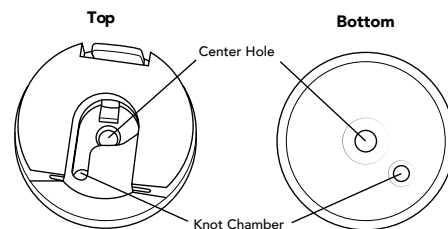

****MAKE SURE THE KNOT DOES NOT INTERFERE WITH THE CONNECTION OF THE SNAP****

18 Apply medium thread lock to the insert threads and attach to the liner.

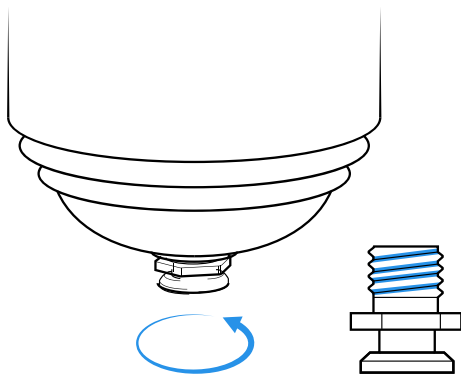

19 Test the snap connection by attaching and detaching 2-3 times.

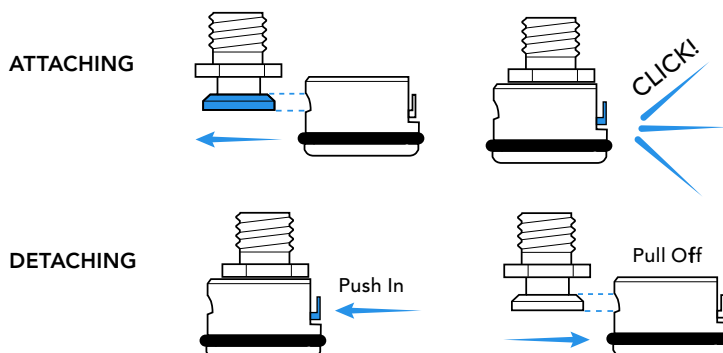

20 Test system for proper function:

Cycle the system 3 times before delivering to verify proper function of the reel.

How to use the Click® Reel

- 1 Turn reel to quickly take up lace.

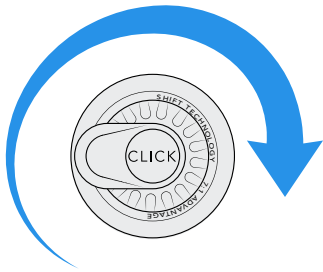

1:1 mode = silent

- 2 Reel will automatically shift to high power mode as it tightens.



7:1 mode = "clicking"

- 3 Micro-adjust by turning forward or backward.

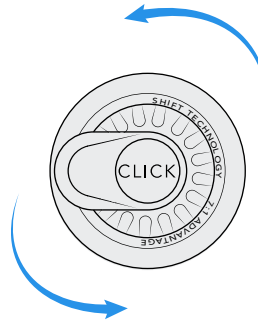

- 4 To fully release, unwind until "clicking" stops.



To remove the Click® Reel:

- Locate the metal insert.
- Insert a small flathead screw driver between the metal insert and the reel body.
- Gently pry the reel upwards.

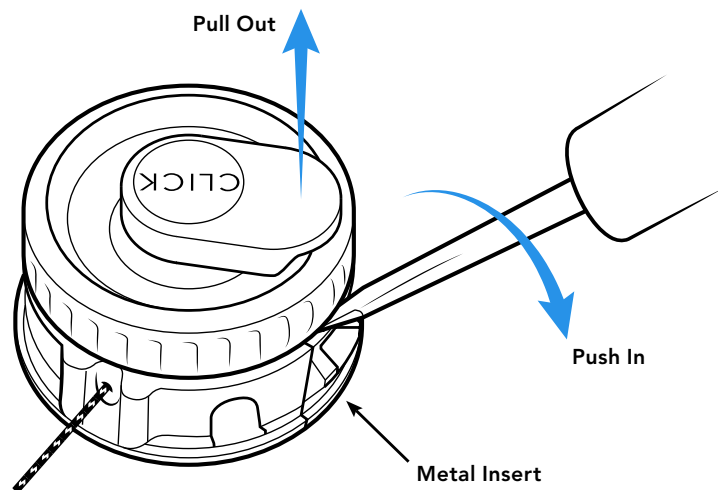

See clickmedical.co/instructions for detailed instructions for replacing/re-lacing a reel.

Teach your patients how to operate the snap to connect the liner:

ATTACHING

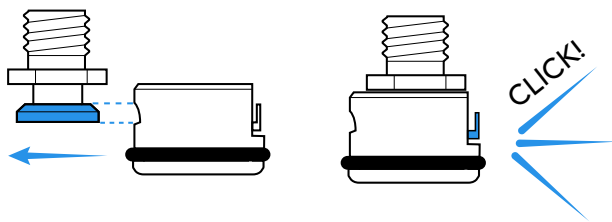

DETACHING

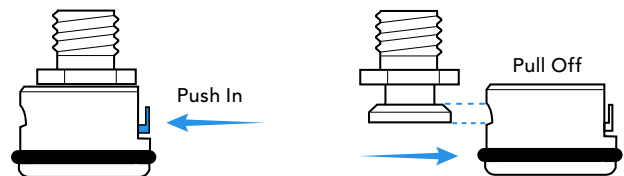

Teach your patients to care for and maintain their RevoLock® system:

Regularly inspect your RevoLock® system.



Inspect lace:

- ✓ Check for wear or damage routinely
- ✓ Replace at any sign of wear
- ✓ Replace lace every 6 months



This product is waterproof and submersible. Rinse with fresh water after use in saltwater, sand, or mud.

Have your patient register their RevoLock® device: <https://clickmedical.co/register/>

NEW LACE

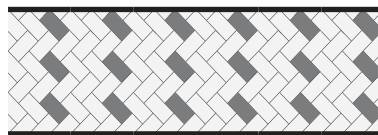

WORN LACE



Look for broken **black** fibers for areas of high wear. If a significant amount of black fibers are broken, then replace the lace.