



## Advisories

**Tool Form for fabrication is sold separately;**

**Click Part Number: RL-310-00-01**

Must be installed by a licensed professional.

Lace will wear:

- Routinely check for wear or damage.
- Look for broken black fibers around areas of high wear.
- Replace lace if a significant amount of black fibers are broken.
- Proactively replace lace every 6 months.
- Loss of suspension can occur if lace fails.
- Keep lace away from open flame and sharp edges.

Secure threaded insert to liner with medium thread lock.

Secure snap to threaded insert before tensioning system.

**Weight limit:** 125 kg

See advisories in other languages: [clickmedical.co/advisories](http://clickmedical.co/advisories)



## WARRANTY

### U.S. Customers:

Contact [www.clickmedical.co/terms/#warranty](http://www.clickmedical.co/terms/#warranty)  
[Help@ClickMedical.co](mailto:Help@ClickMedical.co)

Tel: +1-970-670-7012

### International Customers:

Please contact your local distributor.

**U.S. PATENT: #10918502**

**EU PATENT: PENDING**

<b>MD</b>	<b>MDSS GmbH</b> Schiffgraben 41 30175 Hannover, Germany	<b>CE</b>
<b>EC REP</b>		
		Click Medical, LLC 1205 Hilltop Parkway, W101 Steamboat Springs, CO, 80487, USA +1-970-670-7012

## RevoLock® 4-Hole Kit Contents:

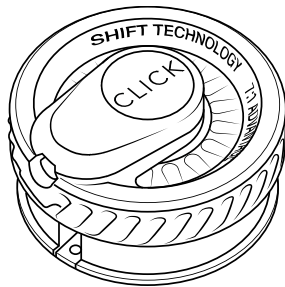

Click® Reel

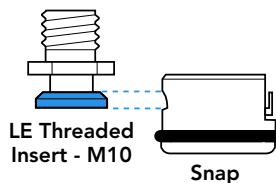

LE Threaded  
Insert - M10

Snap



Lamination Collar

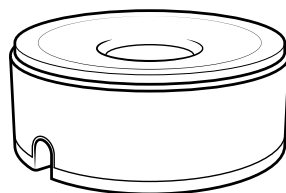

4-Hole Housing

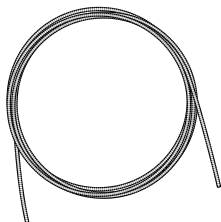

0.5 m  
Lamination Tube



Metal  
Lace Feeder



Tool Form  
Plug

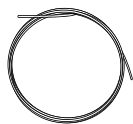

2.0 m  
Indicator Lace

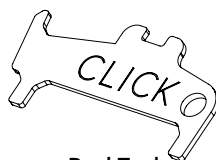

Reel Tool



Plastic Lace  
Feeder x 3

## Overview of Possible Applications:

### Fabricate a New Socket:

1. Determine location of Click® Reel.
2. Secure tool form to model.
3. Apply PVA bag.
4. Apply inner fabric layers.
5. Insert tube into distal housing and reel collar.
6. Apply outer fabric layers.
7. Laminate.
8. Remove form and install distal housing.
9. Lace device, then attach lace to the Click® Reel and the snap.
10. Install Click® Reel into the collar.
11. Test for function.

### Replace a Problem Pin Lock:

1. Remove old pin lock distal housing.
2. Insert and attach RevoLock® distal housing.
3. Route tubing from distal housing slot through old pin lock hole.
4. Determine Click® Reel location and bond collar to socket frame.
5. Cut tubing to length, insert into collar, bond tubing to socket.
6. Remove silicone from collar.
7. Feed lace through collar, tubing and distal housing.
8. Attach lace to snap.
9. Attach the other lace end to the reel and install into collar.
10. Attach threaded insert into liner.
11. Connect threaded insert to snap.
12. Tighten and release system 3x to test function.

## Detailed Fabrication Instructions:

RevoLock® can be fabricated using a single stage or double stage lamination process:

- **For single stage:** follow steps 1-9, then skip to step 17
- **For double stage:** follow steps 1-7, then skip to step 10

For material suggestions and guidelines, please refer to the **Material Data Sheet:** [clickmedical.co/mds](http://clickmedical.co/mds)

- 1 Prepare the inner tool form by inserting a tool form plug into the base.**

**Note:** Tool form plugs are found in each RevoLock® Kit.

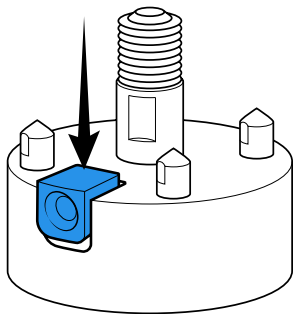

- 2 Determine desired location of reel and mark on the model.**

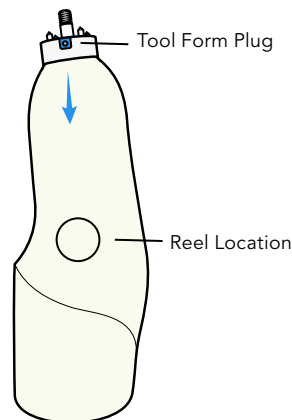

- 3 Orient the tool form plug with the collar and bond the tool form to the model.**

- 4 Apply inner PVA bag:**

- Tape bag to metal form, remembering to allow access to the plug.
- Trim excess.

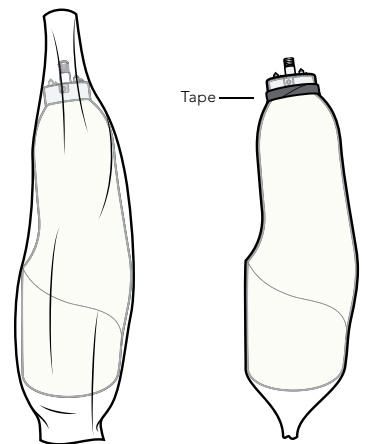

- 5 Apply inner fabric layers:**

Use a hot knife to create access holes for the plug and the 4 pins.

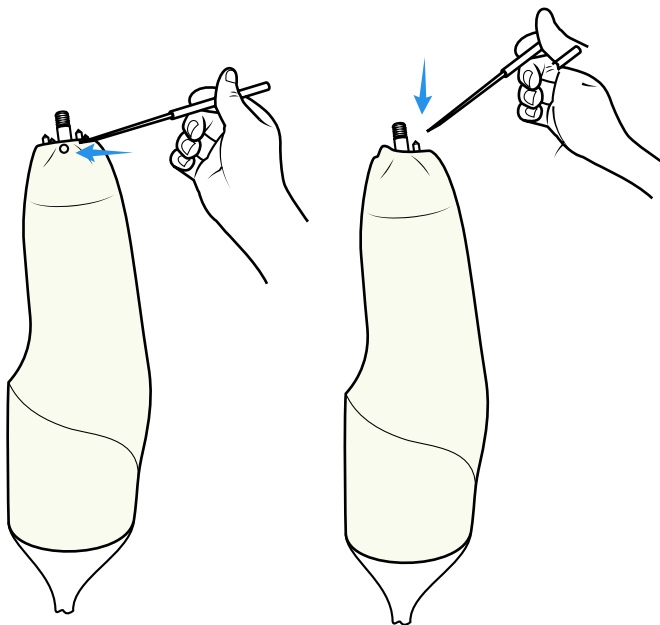

- 6 Install the tubing:**

- Pack tube end with 1 cm of clay.
- Fully insert one end into tool form plug.
- Measure the distance from the plug to the collar, and add 2 cm.
- Cut tube to length, pack with clay and insert into collar (**Lace Port B**).

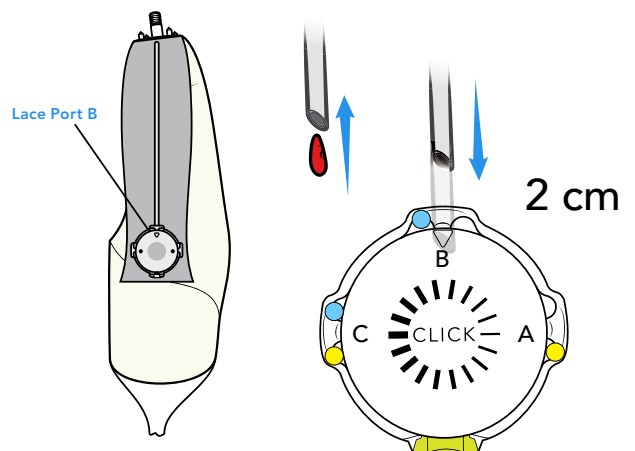

**-- DO NOT KINK THE TUBE --**

If the tube kinks, you must replace with a new piece.

## Detailed Fabrication Instructions (continued):

**⚠ DO NOT EXCEED 15 inHG OF VACUUM PRESSURE DURING LAMINATION**

**7** Apply outer fabric layers.

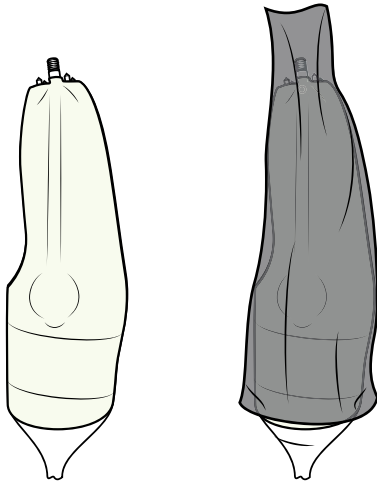

**8** Apply outer former and nut.  
Clay the 2 small holes on top of nut.

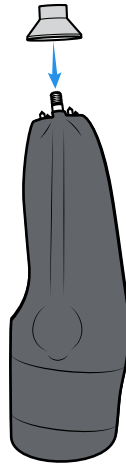

**9** Apply outer PVA bag and laminate.

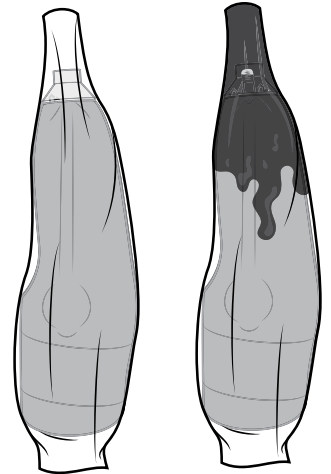

**⚠ REMINDER**

- **For single stage:** follow steps 1-9, then skip to step 17
- **For double stage:** follow steps 1-7, then skip to step 10

**10** Add plastic spacer plate to create void for 2nd lamination, then apply outer former and compression nut.

Clay the 2 small holes on top of nut.

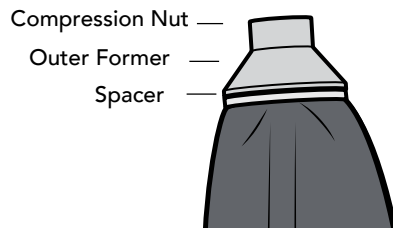

**11** Apply outer PVA bag.

**12** Perform 1st lamination.

**13** Remove compression nut, outer former and spacer plate.

**14** Apply outer fabric layers. Then reapply the outer former and compression nut.

**15** Apply outer PVA bag.

**16** Perform 2nd lamination.

## For All Laminations, Complete These Final Steps:

**17** Tool Form removal:

- Remove compression nut.
- Place parting tool onto the outer former.
- Screw 2 attachment bolts through parting tool and into outer former.
- Screw drive bolt into parting tool to remove the outer former.

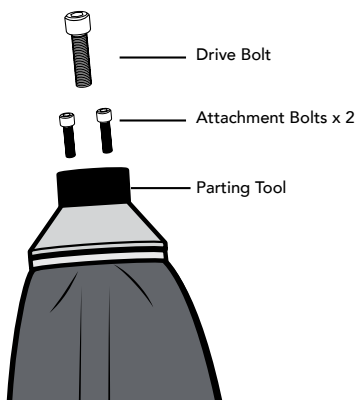

**18** Gently tap center bolt to remove inner tool form and plug.

**Note:** Be careful not to damage threads on the bolt.



**19** Prepare collar:

- Grind to silicone and remove.
- Continue grinding carbon until flat with top of the collar.
- Trim tube end and clear debris.

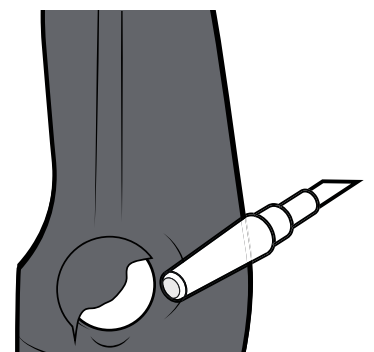

## Detailed Fabrication Instructions (continued):

### 20 Install 4-Hole Housing:

a. Insert distal RevoLock® housing into socket.

**Note:** Align bottom channel to fit over the tubing.

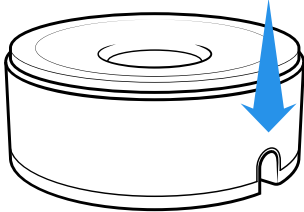

b. Attach alignment hardware and torque to spec (12 Nm).

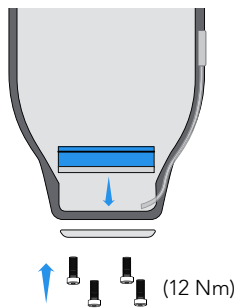

### 21 Lace the device:

Use the lace feeder to feed the lace through tubing starting at the collar.

**Note:** Crimp end of feeder to help steer it up and through the housing.

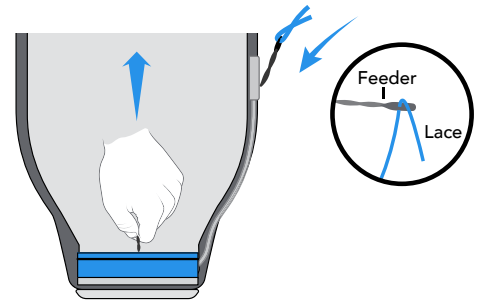

### 22 Attach lace to the snap.

a. Determine lace length for the user to easily connect snap parts, and mark the lace.

**Note:** Max lace length from distal housing = 45 cm.

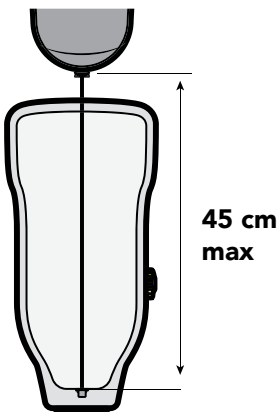

b. Connect the lace to the snap:

1. Thread lace up through the center hole from the bottom of the snap.
2. Then thread lace down through the knot chamber.
3. Tie a double overhand knot.
4. Seat the knot into the knot chamber by pulling on the lace.
5. Seal the hole with a drop of glue.

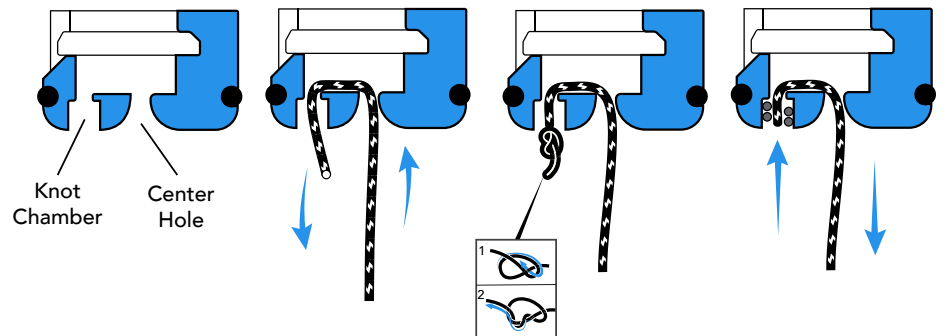

**\*\*MAKE SURE THE LACE DOES NOT INTERFERE WITH THE CONNECTION OF THE SNAP\*\***

### 23 Attach lace to the Click® Reel.

#### Step 1

Orient the reel so that the foot of the reel aligns with the void in the lamination collar opposite of the metal insert.

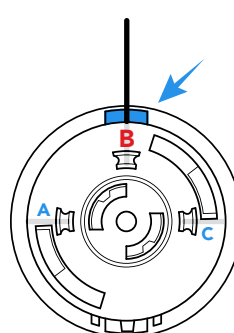
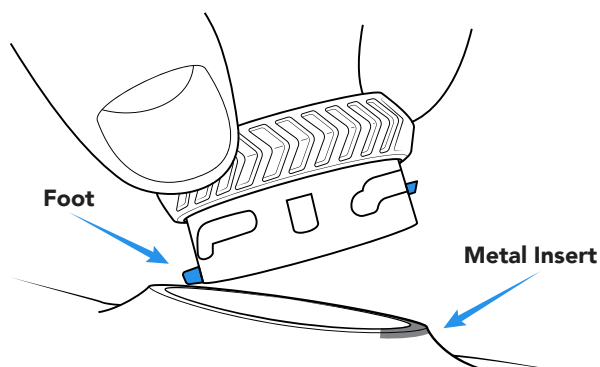

- Use the lace port "B".

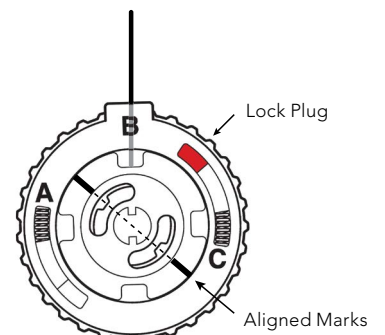

- Ensure lacing windows are aligned. Adjust position by turning dial.

### Step 2

Lace the reel using the plastic lace feeder.

#### Pro Tips:

1. Slightly bend the tip of the lace feeder.
2. Once inserted into lace hole, twist lace feeder to help exit the lace hole.

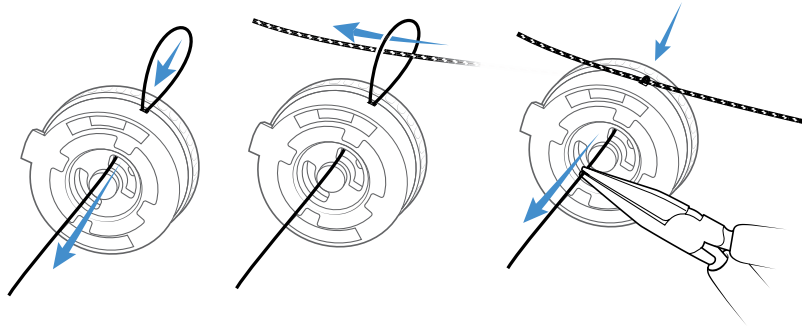

### Step 3

Tie an overhand knot at desired length and trim tail.

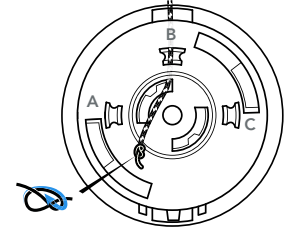

### Step 4

Pull lace to seat knot on the far side of the channel midpoint.

Completely push knot into metal hole with a flathead screwdriver.

Channel Midpoint

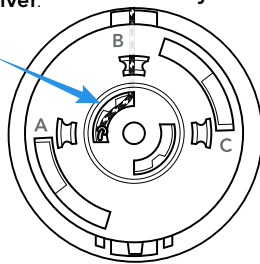

Repeat process for the other end of lace. Leave ~10 cm of slack lace in the system.

### Step 5

Remove the lock plug to engage the Shift® feature of the reel.

Pro Tip: Keep the lock plug for possible future use.

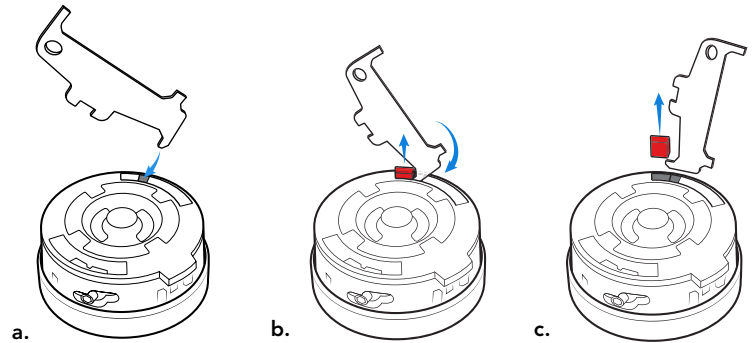

## 24 Install the Click® Reel.

a. Insert the foot of the reel into collar.

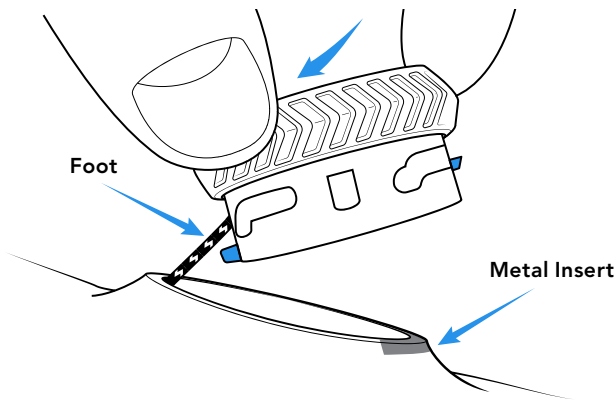

b. Press the reel firmly into the collar (you should hear a "CLICK" when secure).

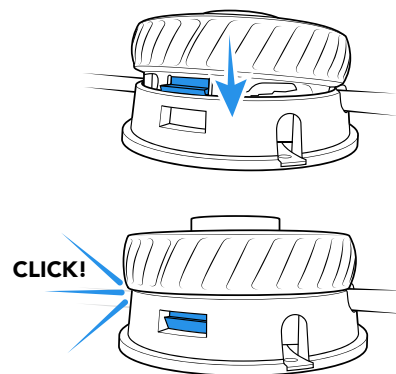

## 25 Apply medium thread lock to the insert threads and attach to the liner.

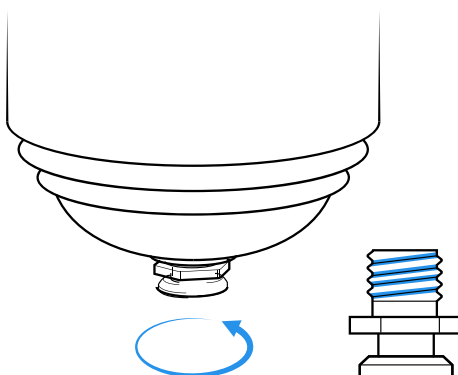

## 26 Test the snap connection by attaching and detaching 2-3 times.

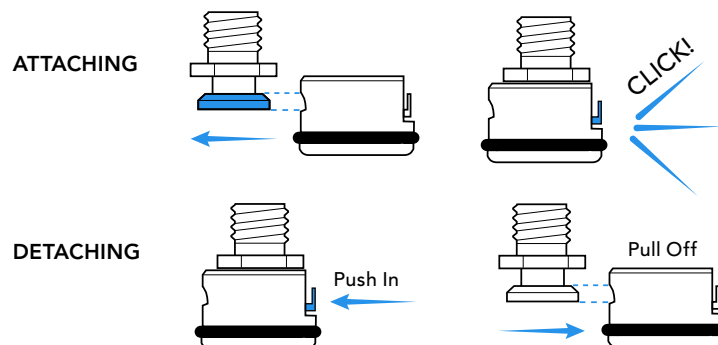

## 27 Test system for proper function:

Cycle the system 3 times before delivering to verify proper function of the reel.

# How to use the Click® Reel

- 1 Turn reel to quickly take up lace.

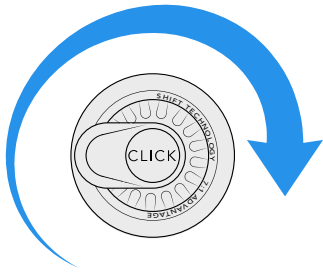

1:1 mode = silent

- 2 Reel will automatically shift to high power mode as it tightens.



7:1 mode = "clicking"

- 3 Micro-adjust by turning forward or backward.

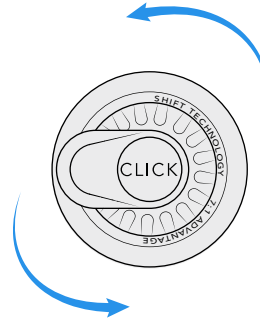

- 4 To fully release, unwind until "clicking" stops.



## To remove the Click® Reel:

- Locate the metal insert.
- Insert a small flathead screw driver between the metal insert and the reel body.
- Gently pry the reel upwards.

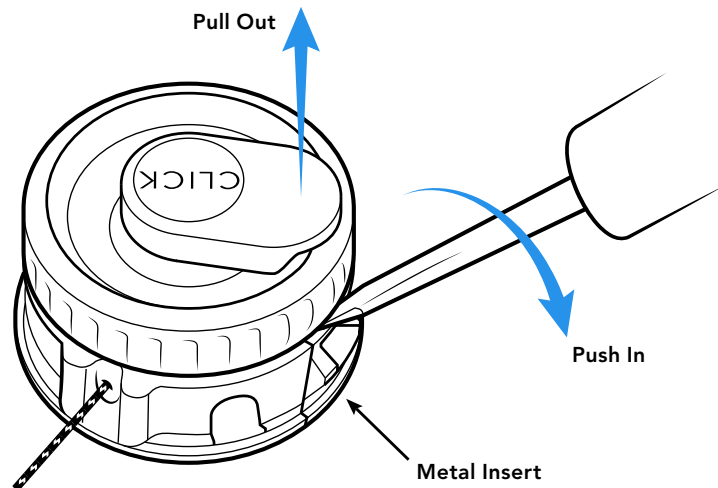

See [clickmedical.co/instructions](http://clickmedical.co/instructions) for detailed instructions for replacing/re-lacing a reel.

## Teach your patients how to operate the snap to connect the liner:

### ATTACHING

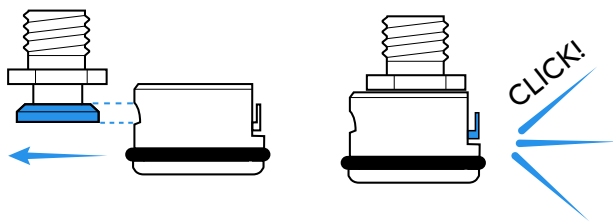

### DETACHING

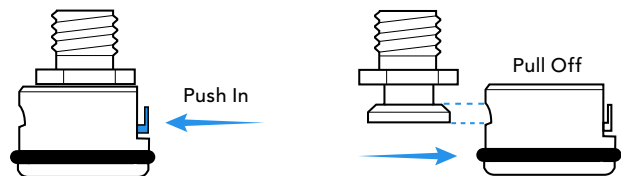

# Teach your patients to care for and maintain their RevoLock® system:

## Regularly inspect your RevoLock® system.



### Inspect lace:

- ✓ Check for wear or damage routinely
- ✓ Replace at any sign of wear
- ✓ Replace lace every 6 months



This product is waterproof and submersible. Rinse with fresh water after use in saltwater, sand, or mud.

Have your patient register their RevoLock® device: <https://clickmedical.co/register/>

### NEW LACE

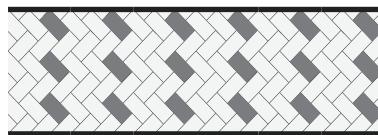

### WORN LACE



Look for broken **black** fibers for areas of high wear. If a significant amount of black fibers are broken, then replace the lace.